

Break Out Box

STS-SJB / STS-SJB-RJ

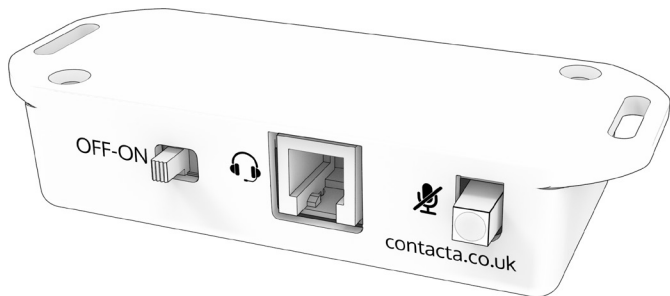

Setup Guide

June 2021

Contents

Product Overview	3
Connections	4
Installation	6

Contacta has a policy of continuous product development, and therefore small specification changes may not be reflected in this manual. Images, labels, packaging, accessories and product colours are subject to change without notice.

Product Overview

The Break Out Box is used in conjunction with Contacta Window Intercom Systems to provide a staff headset output. It enables staff members to use headsets with a microphone, which can be useful in busy or noisy environments.

The unit provides a single headset output for one set of customer/staff using a Window Intercom System.

The Break Out Box can be retrofitted into an existing Contacta Window Intercom System or installed as part of a new system.

It works as an addition to or replacement for a speaker/microphone unit(s) in the Window Intercom System. Once connected it mutes the staff loudspeaker, enabling the staff to hear clearly through a headset.

Two versions are available:

STS-SJB: Uses 3.5mm audio jacks for connection to a headset.

Note: The STS-SJB model is only compatible with headsets which have split 3.5mm plugs for microphone and speaker.

STS-SJB-RJ: Uses an RJ11 socket, compatible with headsets utilising the CSTD 08 connection cable for easy setup.

Connections

Front Panel [STS-SJB]

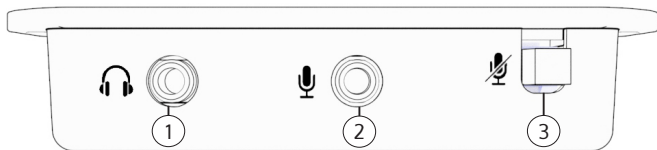

1. **Headphone Port:** 3.5mm audio jack for headphones.
2. **Microphone Port:** 3.5mm audio jack for microphones.
3. **Mute:** Press this button in to mute a connected microphone.

Front Panel [STS-SJB-RJ]

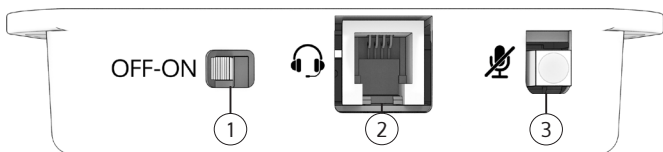

1. **Off/On:** Alternate between speaker/microphone unit(s) ("Off") and a connected headset ("On").
2. **Headset Port:** RJ11 headset port (see next page for details).
3. **Mute:** Press this button in to mute a connected microphone.

Rear Panel

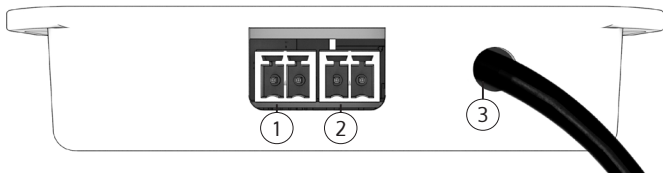

1. **Microphone Port:** Staff microphone connection.
2. **Speaker Port:** Staff speaker connection.
3. **Amplifier [STS-A31H] Connection Cable:** Connection to Amplifier [STS-A31H].

Location / Connections to Amplifier

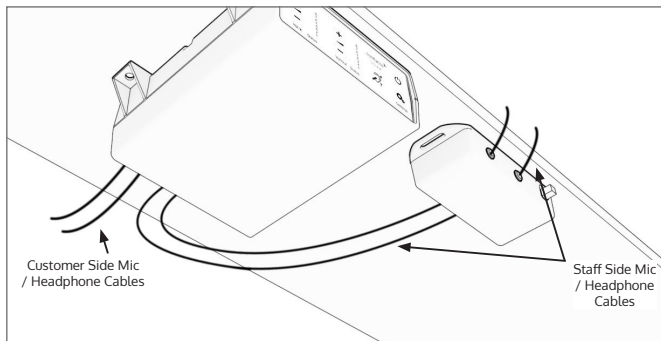

Installation

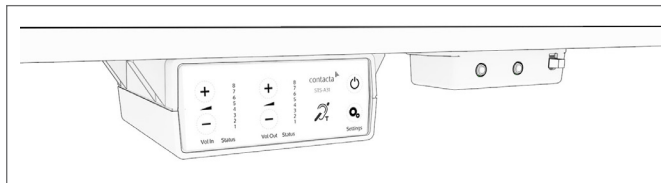

Ensure the following components are accessible:

- Amplifier (STS-A31H).
- A speaker/microphone unit(s) such as the Staff Loudspeaker Unit (STS-SU1-G).

Note: The Break Out Box is ideally fixed using screws on the underside of a counter, located between the Amplifier and the Staff Microphone.

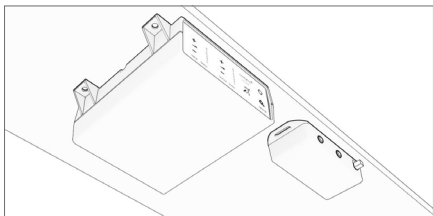
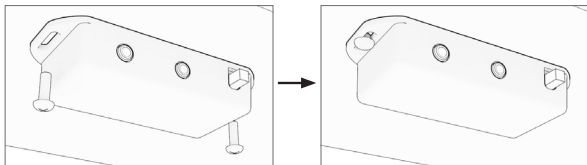

Connecting the Break Out Box

1. Unplug the Staff Speaker (5-6) and Staff Microphone (16-17) connectors from the rear panel of STS-A31H Amplifier [**if installing into an existing system**]. Plug them into the matching speaker and microphone ports at the rear of the Break Out Box (see sketch on page 5).
2. Take hold of the black cable from the right side at the rear panel of the Break Out Box and identify the connectors at its end.
3. Plug the connectors into the Staff Speaker and Staff Microphone ports at the rear of STS-A31H Amplifier:
 - Plug the connector with black/yellow cables into the Staff Speaker port (5-6)
 - Plug the connector with red/black/white cables into the Staff Mic port (16-17)

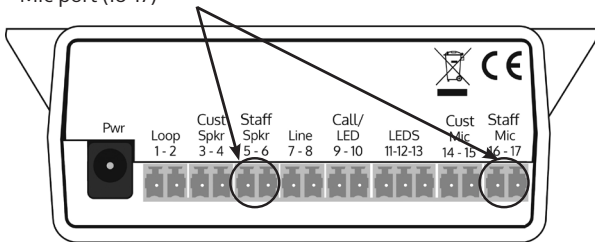

4. Connect your headset to the Break Out Box and test the system.
5. Setup is now complete.



Local dealer:

UK & ROW
+44 (0) 1732 223900
sales@contacta.co.uk

US & Canada
+1 616 392 3400
info@contactainc.com

www.contacta.co.uk